

GHB

Instructions:

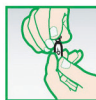

CRACK AMPOULE



INSERT SMALL
AMOUNT OF
SAMPLE



MIX



COMPARE THE
SAMPLE'S COLOR
TO COLOR CHART

TIP:

Scrape a little bit from a pill or use a small amount of powder/crystal, about the size of a pin head

HOW TO DISPOSE OF TEST KIT AFTER USAGE:

Close the ampoule with the cap and dispose of it responsibly. Please do not litter.

results



GHB



@testsuredotcom

MORE INFO

www.testsure.com

TestSure

Disclaimer

The use of this product is at your own risk, it can only give an indication of the substance in the sample therefore, a 100% guarantee can not be provided nor is guaranteed. No rights and or claims can be derived from (the use of) this test. The manufacturer is not liable for damages and / or accidents as a result of the usage of the test.

Testsure Persumptive Drug Identification Tests are NON-DIAGNOSTIC TESTS - these tests are not for Medical Use which are sold worldwide to law enforcement agencies, custom authorities and the general public.

Testsure are field testing kits for the presumptive identification of various substances. Testsure Kits do not contain any controlled or illegal substances. Testsure Kits do NOT contain any organic material.

Produced in the Netherlands.

Harmonized System Code: HS 3822000002

Content contains a strong acid, please keep away from children. Avoid eye contact and skin contact with testing fluid this may lead to irritation. If your eyes or skin come in contact with the testing fluid please rinse with warm water.

This product is meant for entertainment purposes only.